

---

# CANNONS HEALTH CLUB - TELFORD

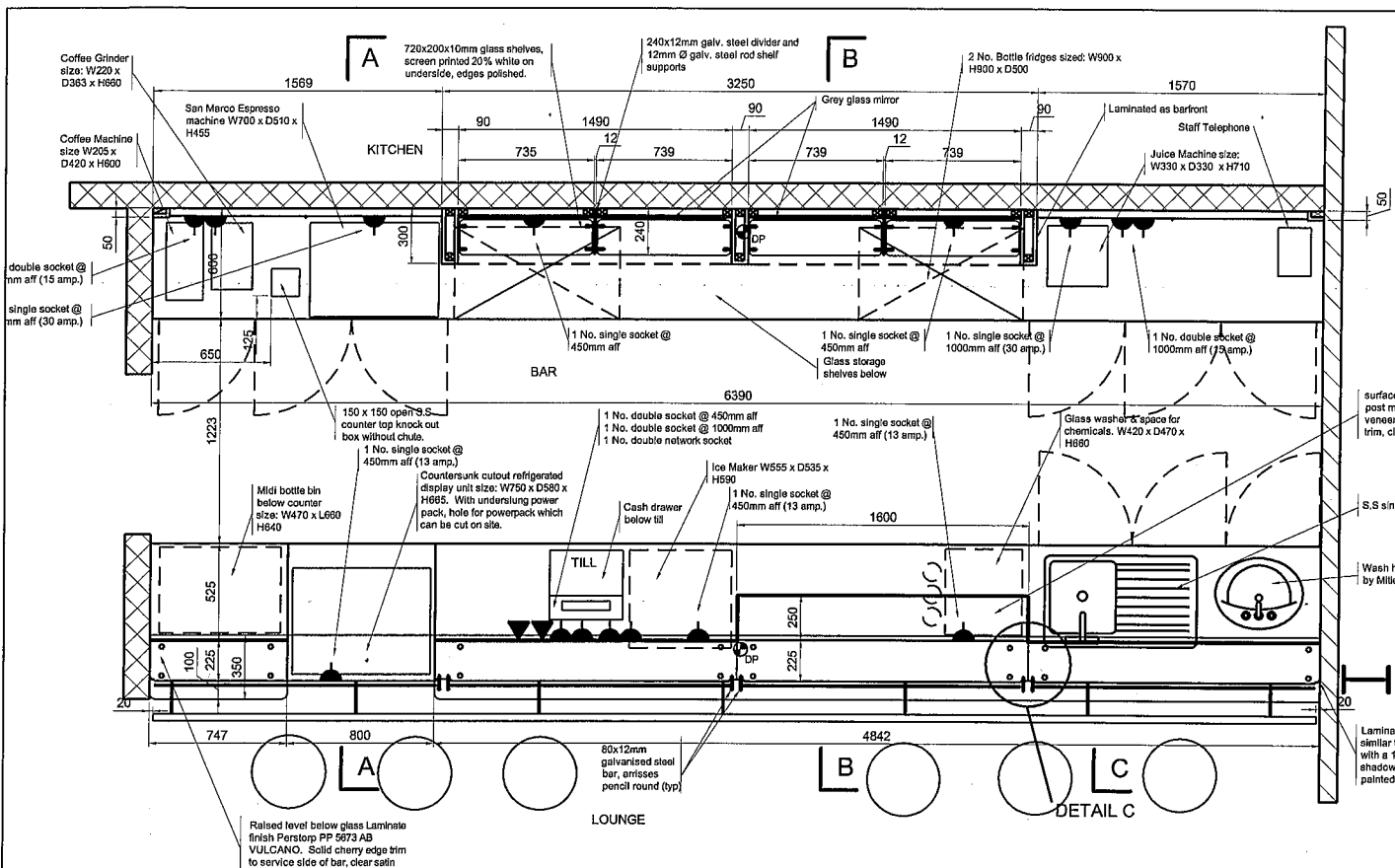

PLAN 1:20

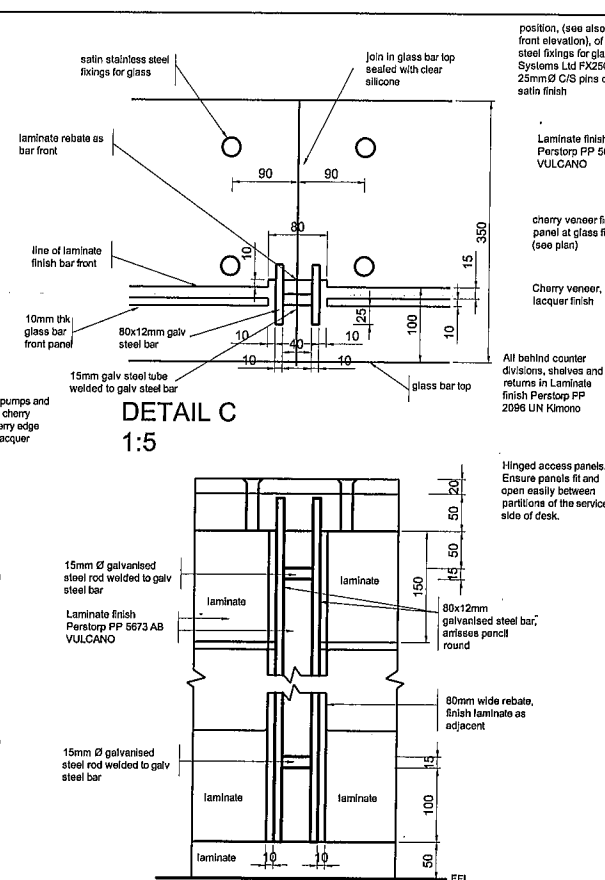

DETAIL C 1:5

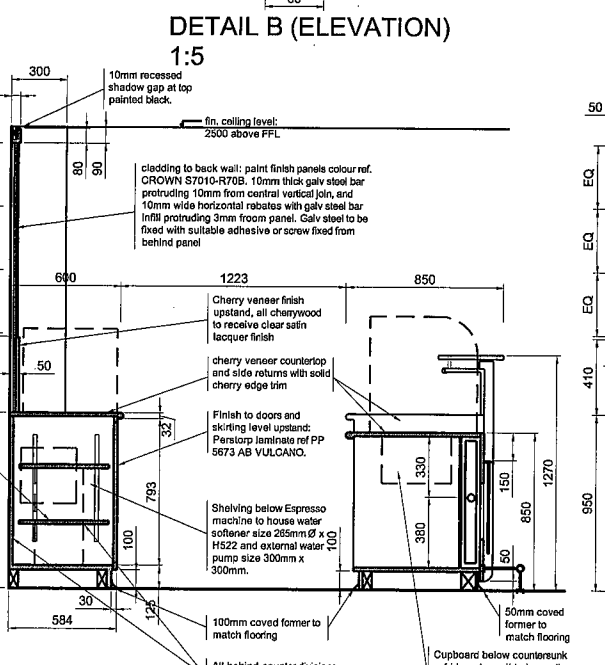

DETAIL B (ELEVATION) 1:5

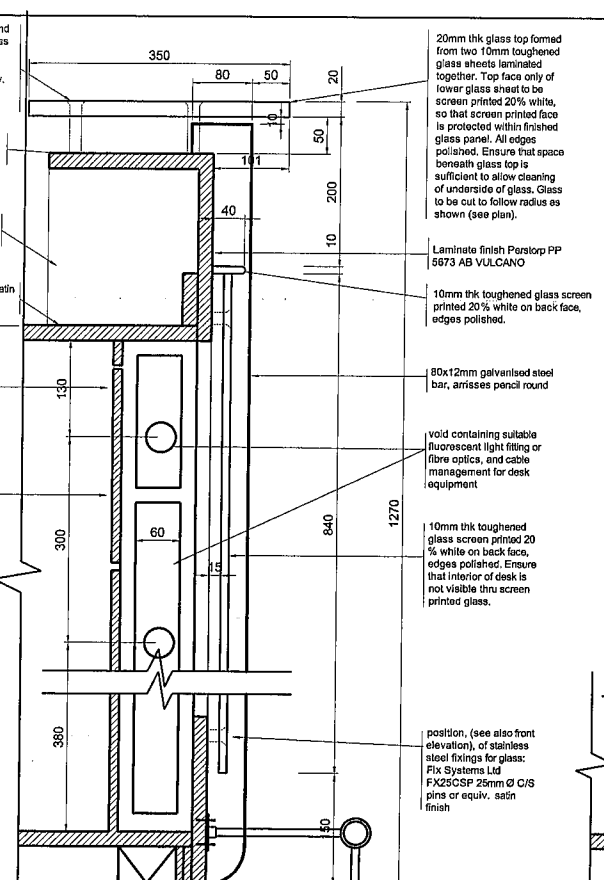

DETAIL SECTION A-A 1:5

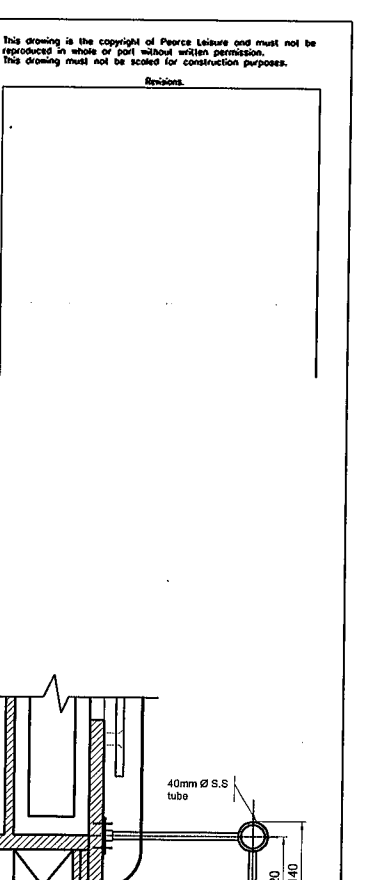

DETAIL D 1:5

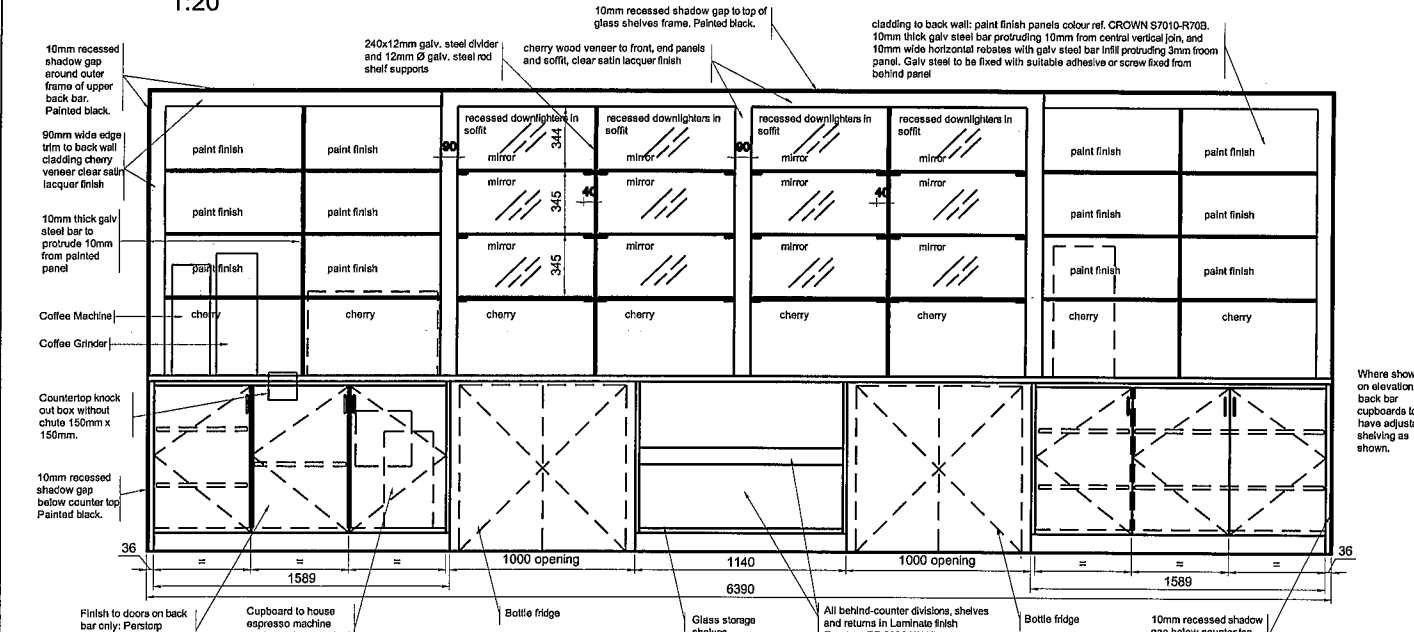

ELEVATION BACK BAR 1:20

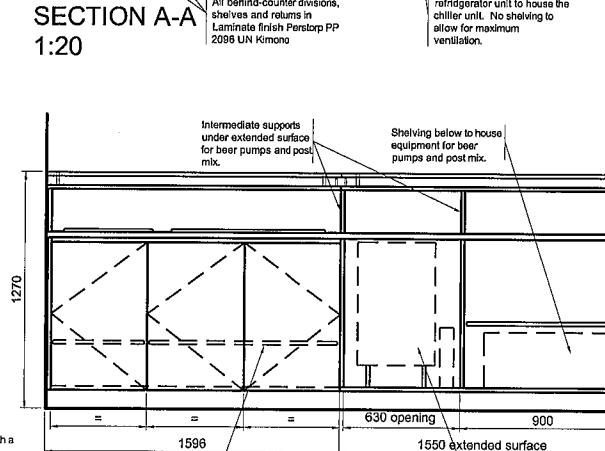

SECTION A-A 1:20

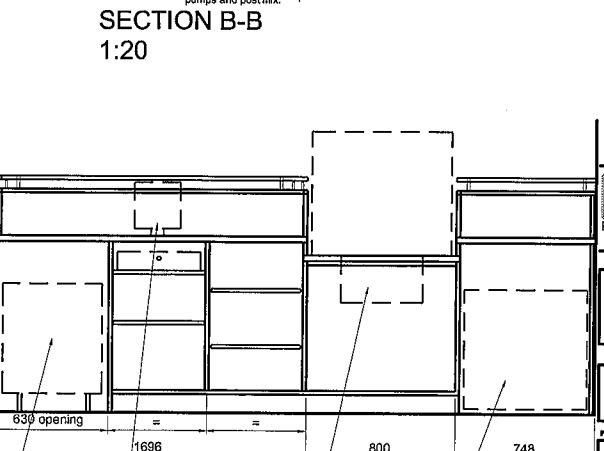

SECTION B-B 1:20

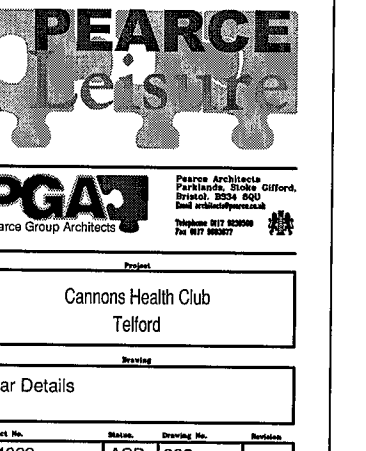

SECTION C-C 1:20

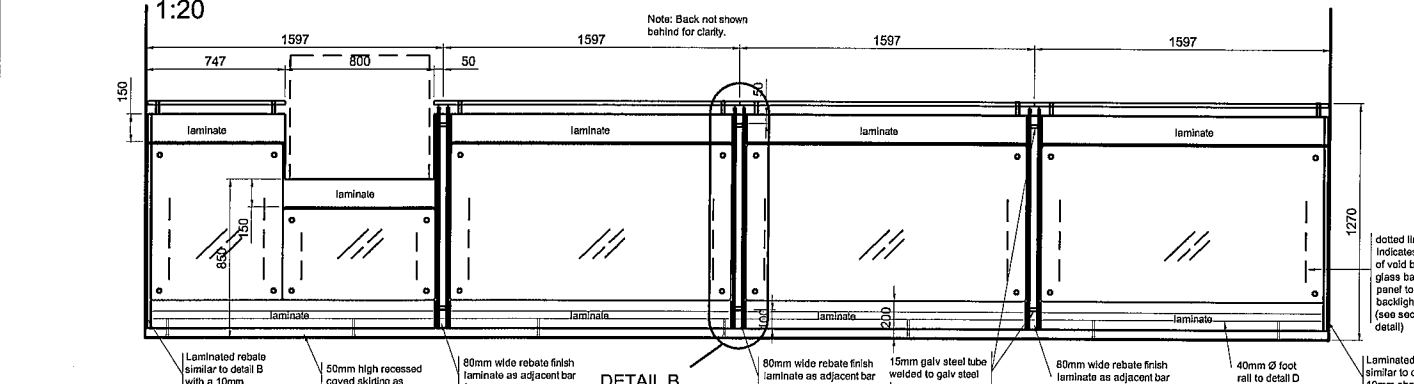

FRONT ELEVATION OF FRONT BAR 1:20

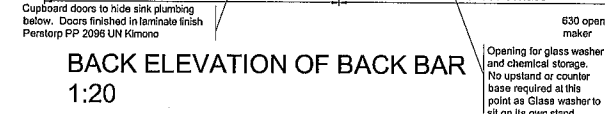

BACK ELEVATION OF BACK BAR 1:20

**PEARCE Leisure**

Pearce Architects  
Partners: Steve Gifford, Brian 3554 800  
and architects@pearce.co.uk  
Pearce Group Architects  
Telephone 01753 82000  
Fax 01753 82027

Project: Cannons Health Club Telford

Bar Details

Project No.	Station	Drawing No.	Revision
14089	ASB	232	
Date	Scale		
AS	1:20 & 1:5		
Checked	Date		
PEARCE LEISURE			